

# GUNTNER ETB BI-FLOW CABINET COOLERS



## Bi-Flow Cabinet Coolers – Medium Temperature

Supplied standard with EC fans & Supercoat Coil Treatment

Airefrig Part Number	Cabinet Cooler Capacity -4°C SST @ 6KTD 4K S/Cooling			ebm EC Axial Fan Motor 230 Volt 50/60 Hz				
	R134a (watts)	R404a (watts)	R22 (watts)	Fan Motor Part Number	Fan Motor Model Number	Watts	Amps	*RPM
ETB5001200	490	538	512	VT03033U	S1G200-CA91-11	30	0.26	2000
ETB6301200	600	659	628	VT03033U	S1G200-CA91-11	30	0.26	2000
ETB7501200	720	791	753	VT03033U	S1G200-CA91-11	30	0.26	2000
ETB8401300	820	900	858	VT03034U	S1G300-CA19-11	40	0.27	1250
ETB11301300	1130	1241	1182	VT03034U	S1G300-CA19-11	40	0.27	1250
ETB13801300	1310	1438	1370	VT03034U	S1G300-CA19-11	40	0.27	1250

\* Note: fan speeds are factory set

Airefrig Part Number	Connections				General Information				Overall Dimensions		
	TX Valve Type	Refrig Inlet (mm)	Refrig Outlet (mm)	Drain Ø (mm)	Fin Spacing (mm)	Fan Ø (mm)	Air Volume m³/hr	Net Weight (kg)	Length (mm)	Depth (mm)	Height including fan & drain
ETB5001200	Int.	9.5	9.5	15	3.0	1 x 200	506	5.1	600	390	159
ETB6301200	Int.	9.5	9.5	15	3.0	1 x 200	474	6.5	600	390	159
ETB7501200	Int.	9.5	9.5	15	3.0	1 x 200	534	6.5	600	390	181
ETB8401300	Int.	9.5	9.5	15	3.0	1 x 300	795	6.6	800	490	184
ETB11301300	Ext.	16	18	15	3.0	1 x 300	829	9.2	800	490	204
ETB13801300	Ext.	16	18	15	3.0	1 x 300	729	11.3	800	490	204

Airefrig Part Number	Dimensions (mm)						
	A	B	C	D	E	F	G
ETB5001200	600	284	140	140	390	217	159
ETB6301200	600	284	140	140	390	217	159
ETB7501200	600	284	140	140	390	217	181
ETB8401300	800	484	140	140	490	317	184
ETB11301300	800	484	140	140	490	317	204
ETB13801300	800	404	180	180	490	317	204

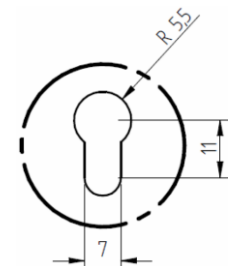
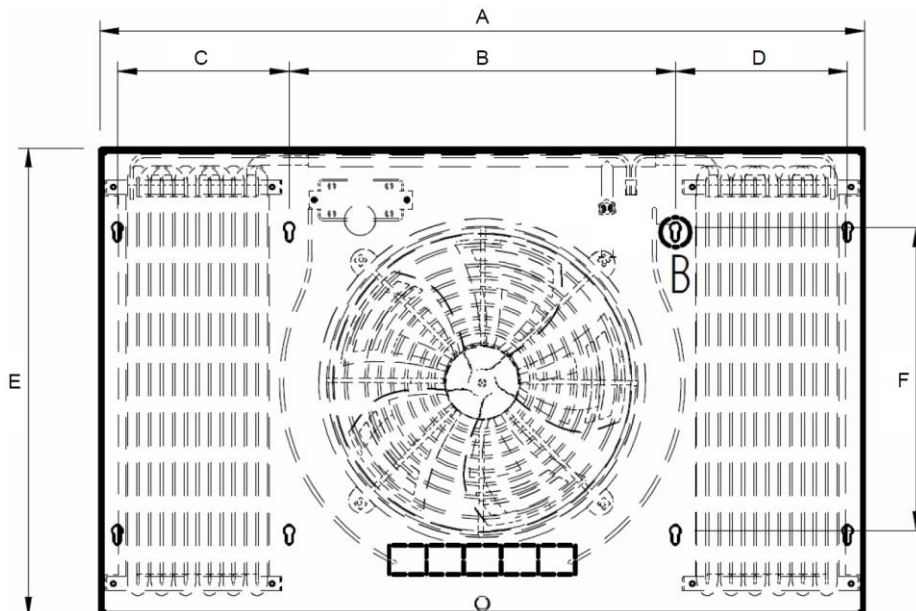
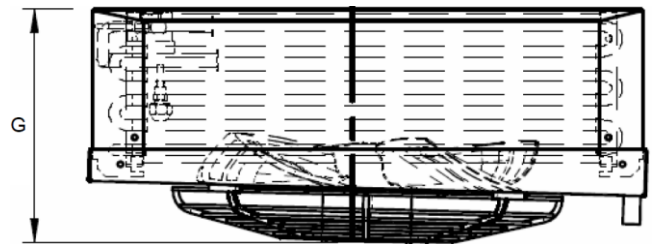

DETAIL B